

# SLENDERWALL®

Architectural Precast Concrete/Steel Stud Building Panels

[www.slenderwall.com](http://www.slenderwall.com)

*Combining Time-Tested Components for Unlimited  
Design Freedom, Unmatched Product Life  
& Unequaled Savings.*

Contributes up to 14 LEED Credits



Virginia's Tallest Building  
38 stories

**Westin Virginia Beach Town Center**  
Luxury Hotel and Residences  
Architect: BBG-BBGM



Available **only** with the SLENDERWALL® panel system:

Architects & Engineers say SLENDERWALL® is “the most significant exterior wall system developed in 40 years.”

### 1 H<sub>2</sub>OUT™

In the Caulk Joint Drainage & Street-Level Leak Detection System

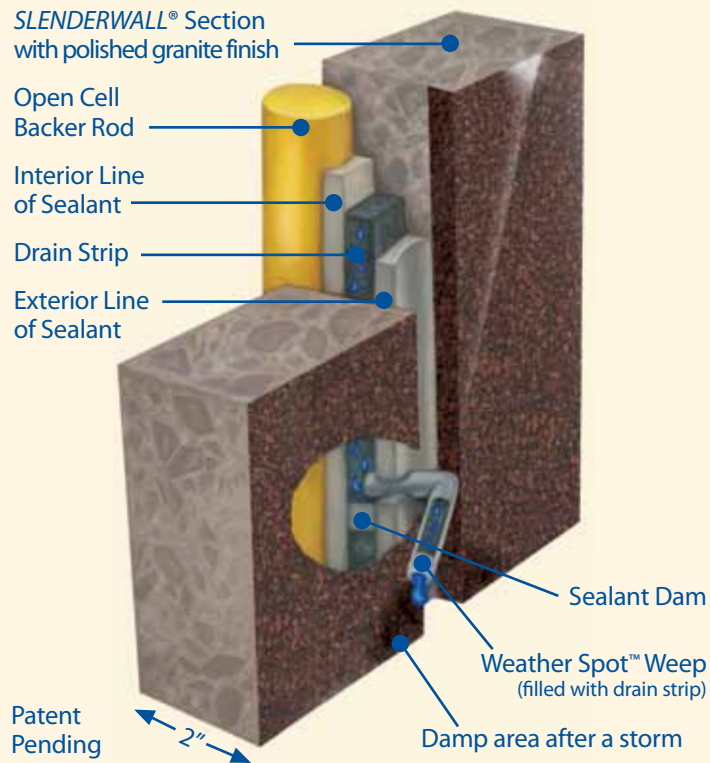

H<sub>2</sub>Out™ is the **only** secondary drainage, street-level, sealant joint leak detection system. If your sealant joints ever fail, leaks exit to the outside of the building and can be located within 20 feet of the failure.

**Benefit:** early detection if sealant joints ever leak.

### 2 DURAFLEX™ 360°

Differential Movement Technology

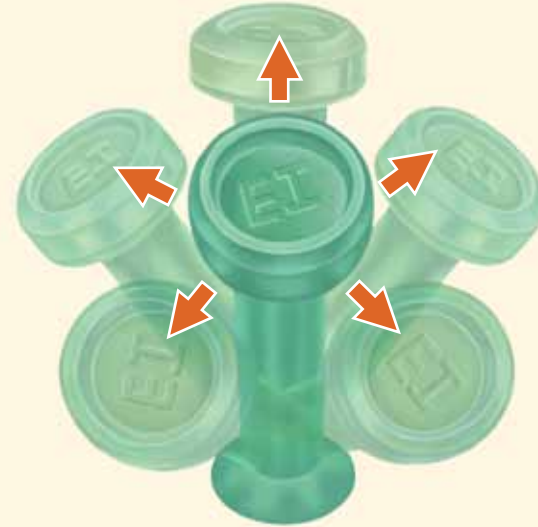

DuraFlex 360°™ is the **only** precast to stud frame connection that allows 360° movement to isolate the precast concrete skin from the structural stresses (wind loading, frame movement, expansion, contraction, and seismic shock).

Duraflex 360°™ has passed applicable ASTM and AAMA test methods, including AAMA 501.4.

**Benefit:** structural integrity and water tightness.

### 3 LIFT-AND-RELEASE™

Fast Panel-Landing System

Lift-and-Release™ is the **only** panel-landing system that makes the installation process faster and easier (19 minutes per panel).

**Benefit:** increases panel installation rates by 50%



Patented

### 4 SECONDNATURE™

Architectural Precast Concrete Brick



Second Nature™ is the **only** “Class A” Architectural Precast Concrete Brick finish with the quality level necessary for “Class A” commercial projects.

**Benefit:** no leaking brick joints

Heavy-gauge galvanized or stainless-steel stud accommodates interior finish

Hot-dipped galvanized reinforcing

High-strength architectural precast concrete, 2-inch thick with high-end fiber for extra strength

1/2-inch air space reduces thermal transfer

Available in a variety of colors, textures and finish combinations

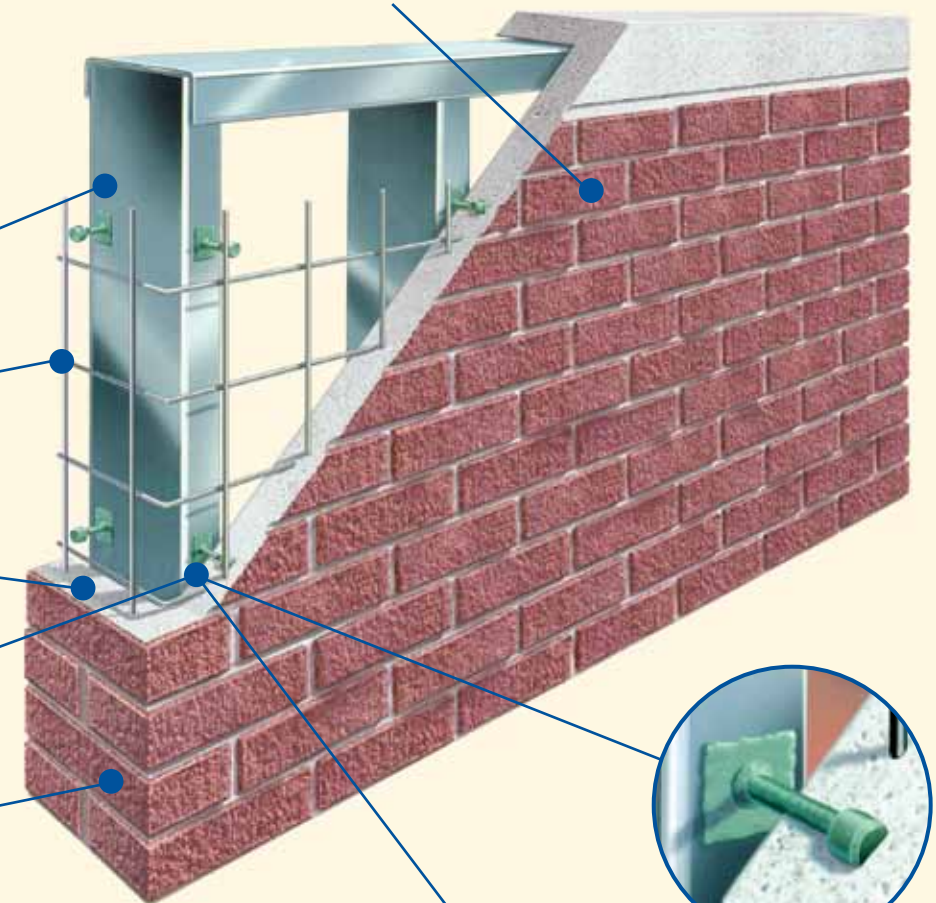

Patented

### 5 THERMAGUARD™

Thermal-Break / Air Barrier Precast Concrete System

ThermaGuard™ is the **only 100% thermal-break/air barrier** precast system. The connection consists of **thermal-break** protection created by both the 1/2-inch air space between the concrete panel and stud, and the exclusive **epoxy-coated stainless-steel stud anchor**. The patented connection prevents corrosion and reduces thermal transfer by as much as 25%.

**Benefit:** reduced heating and cooling costs

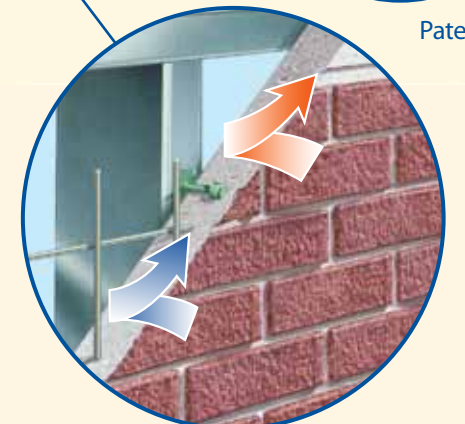

# SLENDERWALL® *It's true! It will make a permanent change in the way you design.*



Marriott Execustay  
3rd Avenue, New York, NY

The **SLENDERWALL®** panel system ends your search for an exterior cladding system that will eliminate wall failures forever.

- **Reduces structural steel and foundation requirements** when compared to conventional methods.
- Designed to **endure structural challenges** such as building frame lateral displacement, beam and floor deflection, column shortening and long-term creep.
- **Eliminates corrosion** by utilizing corrosion-proof and rust-proof materials.
- Specially formulated precast concrete mix provides a **maintenance-free, waterproof** panel that minimizes vapor infiltration.
- Major cost savings on **cantilevered** structure designs.

*"I started the trend of using SLENDERWALL® on high rise buildings in New York City. I think that the SLENDERWALL® system will be used on many buildings in New York in the future."*



H. Thomas O'Hara  
H. Thomas O'Hara Architect, PLLC



New Jerusalem Baptist Church  
Queens, NY



County Administration Building, Civic Square II  
New Brunswick, NJ



Bradley Hall, Rutgers University  
Newark, NJ

*"What attracted us to this product is the 2" thick precast concrete in an economical panelized format with steel-stud backup. This significantly reduced the cost of the structural frame and foundation required to support this much lighter system.*

*Thus, we could achieve the beauty of a precast concrete or masonry exterior in a more cost-effective and efficient manner.*

*Currently we are on our fifth project using SLENDERWALL®."*



Edward N. Rothe, FAIA  
Rothe-Johnson-Fantacone

The **SLENDERWALL®** panel system allows the design freedom to create a lasting impression.

- Uses **time-tested, proven** components.
- Provides the **permanence** of architectural precast concrete. It will not dent, rust, burn, warp or delaminate.
- Offers **custom shapes and sizes**, radii, bull noses, reveals and returns manufactured to tight tolerances in year-round climate-controlled factories.
- Designed for **load-bearing** or **curtain wall** applications.



Hock Plaza II  
Durham, NC

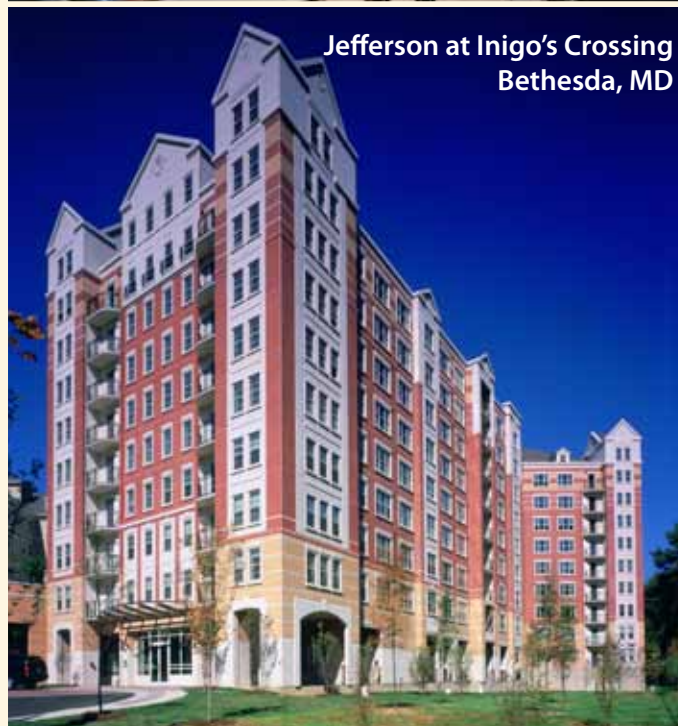

Jefferson at Inigo's Crossing  
Bethesda, MD



New Jersey Institute of Technology  
Newark, NJ  
Left: New construction  
Right: Reclad

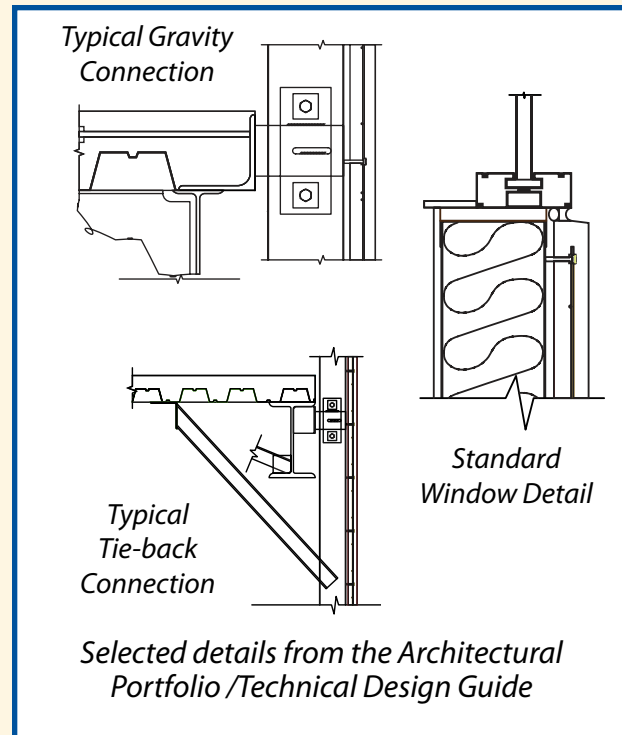

The **SLENDERWALL®** panel system is a permanent, lightweight, cost-and-time-saving exterior wall system.

- **Eliminates** staggering recladding costs and responsibility battles by using permanent components.
- **Lightweight panels** are only 30 lbs. per square foot, including the heavy-gauge steel framing.
- **Reduces installation time and costs** by up to 50% due to exclusive **Lift-and-Release™** panel-landing system.
- **Reduces construction costs** because smaller cranes can be used during installation.
- **Reduces on-site weather costs** and delays as well as on-site construction debris.
- **Reduces shipping costs** by 60% since more lightweight panels can be shipped on each load.
- **Increases leasable floor space income** by mounting panels outboard of floor slab.



Jefferson at Thomas Circle  
Luxury Apartments  
Washington, DC

## Finishes

Choose from a wide variety of **standard** and **custom colors and concrete finishes** for the 2-inch thick exterior precast concrete surface. Individual panels can contain architectural details and **multiple finishes**.



\* Second Nature™  
(Architectural Precast Brick)



Capitol Granite



Colorado Granite



Desert Limestone

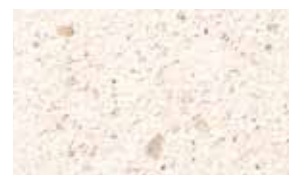

Sandstone



Carolina Granite



Indiana Limestone

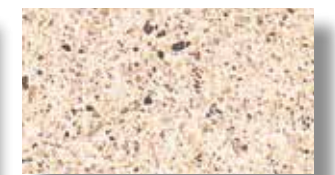

Buff Limestone

\* Second Nature™ is the only precast concrete brick reproduction approved by historical societies and architects for use on high profile architectural projects.

Call today to qualify for your free copy of the **SLENDERWALL®** Architectural Portfolio/ Technical Design Guide (308 pages).

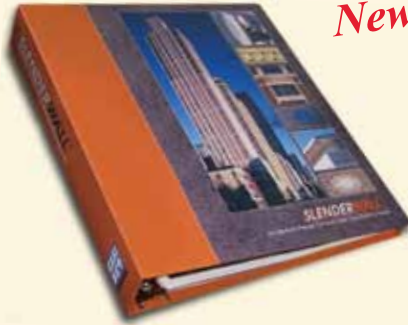

**New!**

## LEED Friendly

Energy and Atmosphere	Credits
• Optimize Energy Performance	1 - 4
Materials and Resources	
• Construction Waste Mgmt	1 - 2
• Recycled Content	1 - 2
• Regional Materials	1 - 2
Innovation and Design Process	
• Life Cycle CO <sub>2</sub> Reduction	1
• Durability	1
• Resource Efficient Cladding	1
• LEED Accredited Professional	1

Contributes up to **14 LEED Credits**

## ARCHITECTURAL TESTING INC.

All tests performed by certified independent testing laboratory using nationally recognized standards and methods.

Earthquake, hurricane and tornado level testing establishes **SLENDERWALL®** as the wall system of choice for severe conditions.

- ✓ Preload at 50% design.....ASTM E330
- ✓ Air Infiltration.....ASTM E283
- ✓ Static Pressure Water Resistance.....ASTM E331
- ✓ Dynamic Pressure Water Resistance...AAMA 501.1
- ✓ Structural Performance.....ASTM E330
- ✓ Seismic Movement (Interstory).....AAMA 501.4
- ✓ Thermal Cycle.....AAMA 501.5
- ✓ Thermal Transmittance.....AAMA 1503
- ✓ Sound Transmission.....ASTM E90
- ✓ In-situ Water Test.....AAMA 503.03
- ✓ Fire Resistance Rating.....ASTM E119

**DURAFLEX® 360°** technology used on all tests.

Detailed report for 60 psf windload **SLENDERWALL®** panels available upon request along with 12 additional test methods.

### Visit [www.SlenderWall.com](http://www.SlenderWall.com) for:

- Architectural Portfolio/Technical Design Guide
- AutoCAD and PDF drawings
- Product information & project summaries
- Specifications

### Become a Registered Member:

- Download AutoCAD files
- View technical information

Call today to discuss **SLENDERWALL®**...your exterior architectural precast concrete panel solution.

### Affiliations:

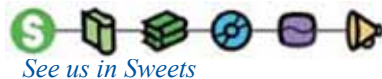

### Manufactured locally by:



5119 Catlett Rd • PO Box 400 • Midland, VA 22728 • (800) 547-4045 • [www.easiset.com](http://www.easiset.com) • [info@easiset.com](mailto:info@easiset.com)  
 EASI-SET® Industries is a licensor of precast products worldwide, and a wholly-owned subsidiary of Smith-Midland® Corporation, a publicly traded company. ©2008 by EASE-SET® Industries. All rights reserved.